

ART.
05

LEVIGATRICE A NASTRO + PULTRICE
BELT GRINDING + POLISHING MACHINE
TANK + POLISSOIR
BANDSCHLEIF-UND POLIERMASCHINE

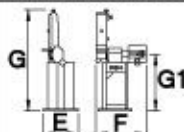

Volt 400 kW 1,8



hp	Rpm	m/s	dB	E	F	G	G1	kg
2,5	1400 2800	10 20	70	600	900	1600	910	115

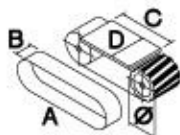

NOT
INCLUDED



OPTIONAL

A	B	C	D	Ø	Ø mm	IA-2
1500	120	470	120	135	Ø250xØ25	kW 0,55

